

Production of printed banner

The banner material can be vinyl, fabric, double sided laminated paper etc.

Recommended maximum thickness of material: 0,45 mm (0.018")

Banner dimensions

Visible part of banner material:

206 cm (81")

With extension pole, item 89255 = 225 cm (89").

Printed length of banner:

210 cm (83")

With extension pole = 229 cm (90").

Min. extra banner material (unprinted): 30 cm (12")

Total length of banner material:

240 cm (95")

With extension pole = 259 cm (102").

Width, max (do not exceed):

88 cm (34.65"), 100 cm (39.35")

120 cm (47.25"), 150 cm (59.05")

<p>Full height, 3 pole sections Visible banner height: 206 cm (81") <i>With extension pole, item 89255 = 225 cm (88").</i></p> <p>Total banner length: 240 cm (95")</p>
<p>Mid-height, 2 pole sections Visible banner height: 140 cm (55")</p> <p>Total banner length: 174 cm (69")</p>
<p>Lowest height, 1 pole section Visible banner height: 73 cm (29")</p> <p>Total banner length: 107 cm (42")</p>
<p>Additional print: 4 cm (1.5")</p> <p>Extra banner material (unprinted): 30 cm (12")</p>



Facts

	88 (3 ft.)	100 (40 in.)	120 (4 ft.)	150 (5 ft.)
Banner width	88 cm (34.65")	100 cm (39.35")	120 cm (47.25")	150 cm (59.00")
Full height w/ cassette	212 cm (83.5")	212 cm (83.5")	212 cm (83.5")	212 cm (83.5")
Visible banner height	206 cm (81")	206 cm (81")	206 cm (81")	206 cm (81")
Weight (excl. banner)	5,4 kg (11.8 lbs)	5,8 kg (12.7 lbs)	7,3 kg (16.0 lbs)	8,5 kg (18.7 lbs)
Cassette dimension	14x11x89 cm (5.5"d x 4.5"h x 35"w)	14x11x101 cm (5.5"d x 4.5"h x 40"w)	14x11x121 cm (5.5"d x 4.5"h x 48"w)	14x11x151 cm (5.5"d x 4.5"h x 59.4"w)
Item No.	81115	81116	81117	81118

Accessories

Extension pole

for visible height of 225 cm (88"), item no. 89255

Quick-change banner mounting kit

1 pair of banner rails (top and bottom) with mounting tape and 6 plastic push pins. (1 kit included in 81115/81116/81117/81118).

88 (3 ft.)	100 (40 in.)	120 (4 ft.)	150 (5 ft.)
Item no. 81020	Item no. 81030	Item no. 81040	Item no. 81050

For other accessories, such as carrying cases, spotlights etc., see our general price list.



Patent pending PCT/SE00/01852

999 1 05/01.02.2003

Assembly instruction

88 cm (3 ft.) – 100 cm (40 in.)



For increased stability pull out the four support legs on the cassette.



Take two of the pole sections (start with the untapered) and mount these on the cassette.

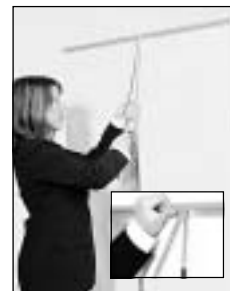

Pull the banner halfway out of the cassette. Hook the third pole section to the top rail of the banner. Push the banner up to full height to complete pole assembly.

120 cm (4 ft.) – 150 cm (5 ft.)



For increased stability pull out the four support legs on the cassette.



Mount all six pole sections on the cassette (start with the untapered).



Pull the banner up to full height and hook the poles to the top rail of the banner.

Mounting of printed banner

Top rail

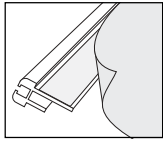

1

Mount the top rail on the **reverse side** of the banner, parallel to the upper edge.

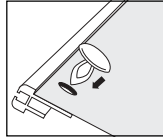

Maximum security.

Carefully make holes in the banner to align with the holes in the rail. Insert the plastic push pins provided.

Bottom rail

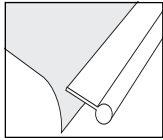

Mount the bottom rail on the **reverse side** of the banner.

Important:

Clean the banner carefully with suitable cleaning solvents and press hard when mounting the rails.

For the glue to set and harden, we recommend attaching the rails 24 hours before loading the banner into the cassette.

IMPORTANT !

Roll **laminated** banners **print-side out**.
Roll **non-laminated** banners **print-side in**.

Slide the bottom rail into the cassette.

2



3



Hold the banner and remove the locking pin.

Never pull out the "Locking Pin" until a banner is loaded into the cassette

Let the banner **slowly** roll into the cassette.

4



Change of printed banner

1



Roll the old banner out of the cassette.

2



Insert the locking pin.

3



Slide the banner out.

Mount two **new** rails (one Quick-change kit) on to the new banner.

Follow "Mounting of printed banner" on the previous page.

TENSION ADJUSTMENT

All cassettes are pretensioned before delivery.



Do not overtension!

If adjustment is needed, hold the cassette firmly in place then depress and turn the adjusting screw clockwise to increase the tension (the tension mechanism adjusts in halfturn increments). Slowly release pressure on the screw turning slightly counterclockwise and allow it to again lock in place. If tension has been lost completely, we recommend 20-25 full clockwise turns.